

BILL OF MATERIALS

ITEM	DESCRIPTION	MATERIAL	LENGTH	QTY.
1	CHECKER PLATE, 3/16"	A36/44W		A/R
2	BEAM-WF, W10 X 15 LB/FT	A572-50		A/R
3	STANDARD CHANNEL, C4 X 5.4 LB/FT	A572-50		A/R
4	LIFT LUG - PLATE, 1" (SEE DETAIL)	A36/44W		4
5	GRATING - WELDED BAR SERATED, 1" X 3/16"	A36/44W		A/R

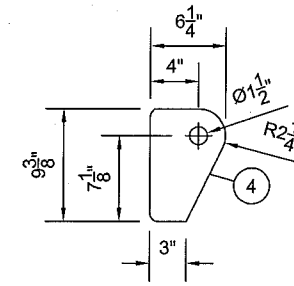

LIFT LUG
N.T.S.

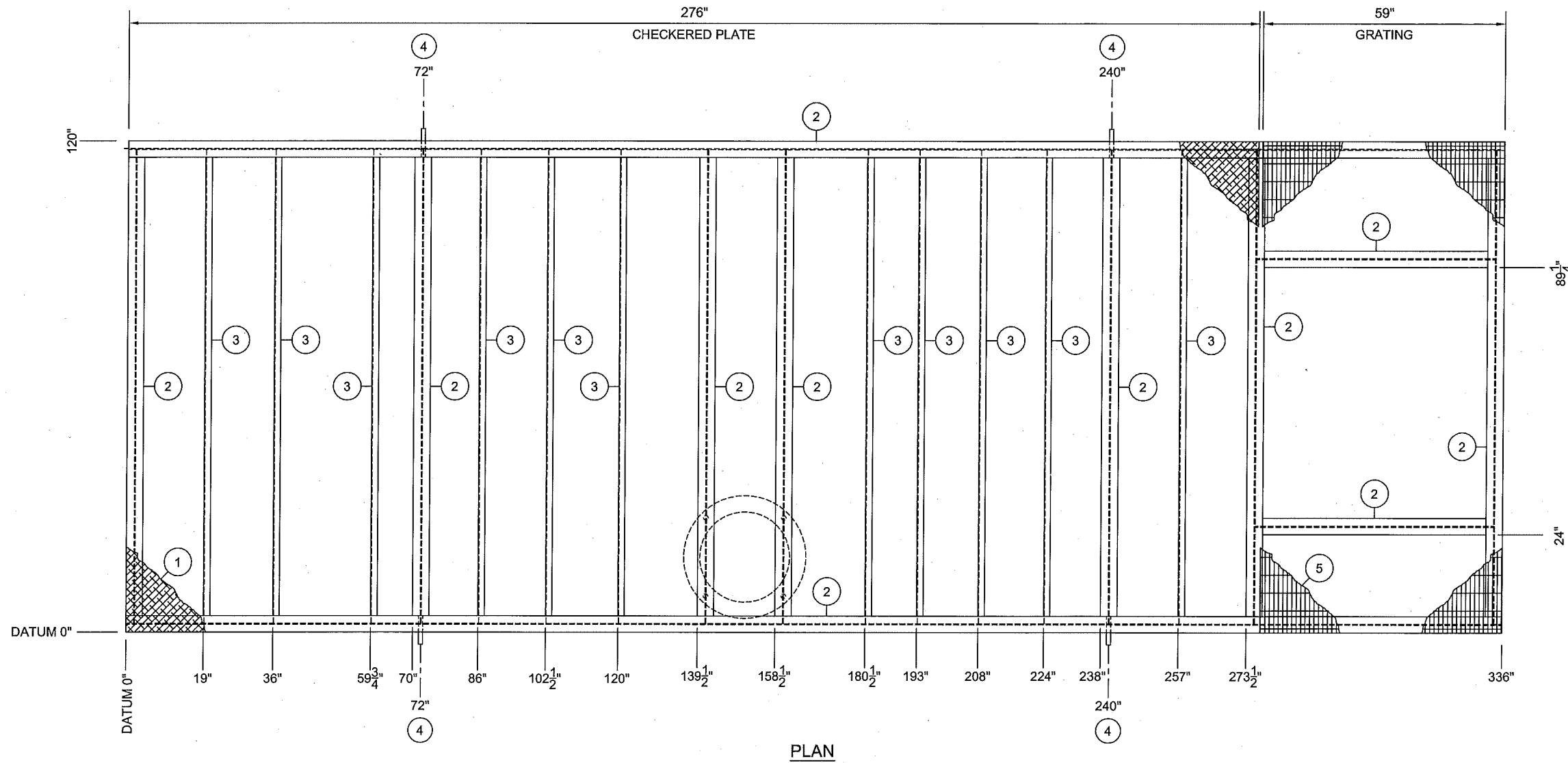

PLAN

GENERAL NOTES

1. QUALITY CONTROL PROGRAM NUMBER IS AQP-1464
2. GENERAL DEVIATION TOLERANCE IS $\pm 1/8$ "
3. COPE STRUCTURAL STEEL AS REQUIRED
4. ALL WELDS ON THE SURFACE TO BE GROUND FLUSH FOR FLOOR PLATE
5. APPROXIMATE WEIGHT: 5300 lbs
6. SMAW, MCAW, OR FCAW PROCESSES ALLOWED, NO GMAW
7. MCAW PROCESSES ON ALL LIFT LUGS
8. SKID TO MEET CWB REQUIREMENTS

PAINTING

SURFACE PREPARATION: SSPC-SP3
 PRIMER: RUST-OLEUM QUICK DRY ENAMEL
 TOP COAT: RUST-OLEUM HIGH GLOSS ENAMEL
 TOP COAT THICKNESS: 1.5 TO 2.0 MILS DFT
 TOP COAT COLOR: LIGHT MACHINE GREY
 INSULATION: 2-1/2" URETHANE c/w FIRE RETARDANT CONFORMING TO ASTM E84

REV.	DATE	DESCRIPTION	BY	CHK'D	APP'D
1	03/15/13	AS BUILT		DB	WJ
0	09/27/12	ISSUED FOR CONSTRUCTION		DB	LW PC



CUSTOMER: **PennWest Exploration**
 TITLE / PROJECT: **3" INLET (10-WELLS) / 4" HEADER**
24" OD X 60" S/S X 720 PSI
AB SOUR TEST SEPARATOR PKG

DRAWING NAME: SKID	QUANTITY: 1	PACKAGE SERIAL NO. (S): 12-052-1
JOB NO.: 12-052	DRAWN BY: D. BRYAN	DATE: 09/14/12
REV. NO.: 1	SHEET NO.: 1 OF 1	SCALE: 3/8"=1'-0"
		DRAWING NO.: 12-052-SKID

