

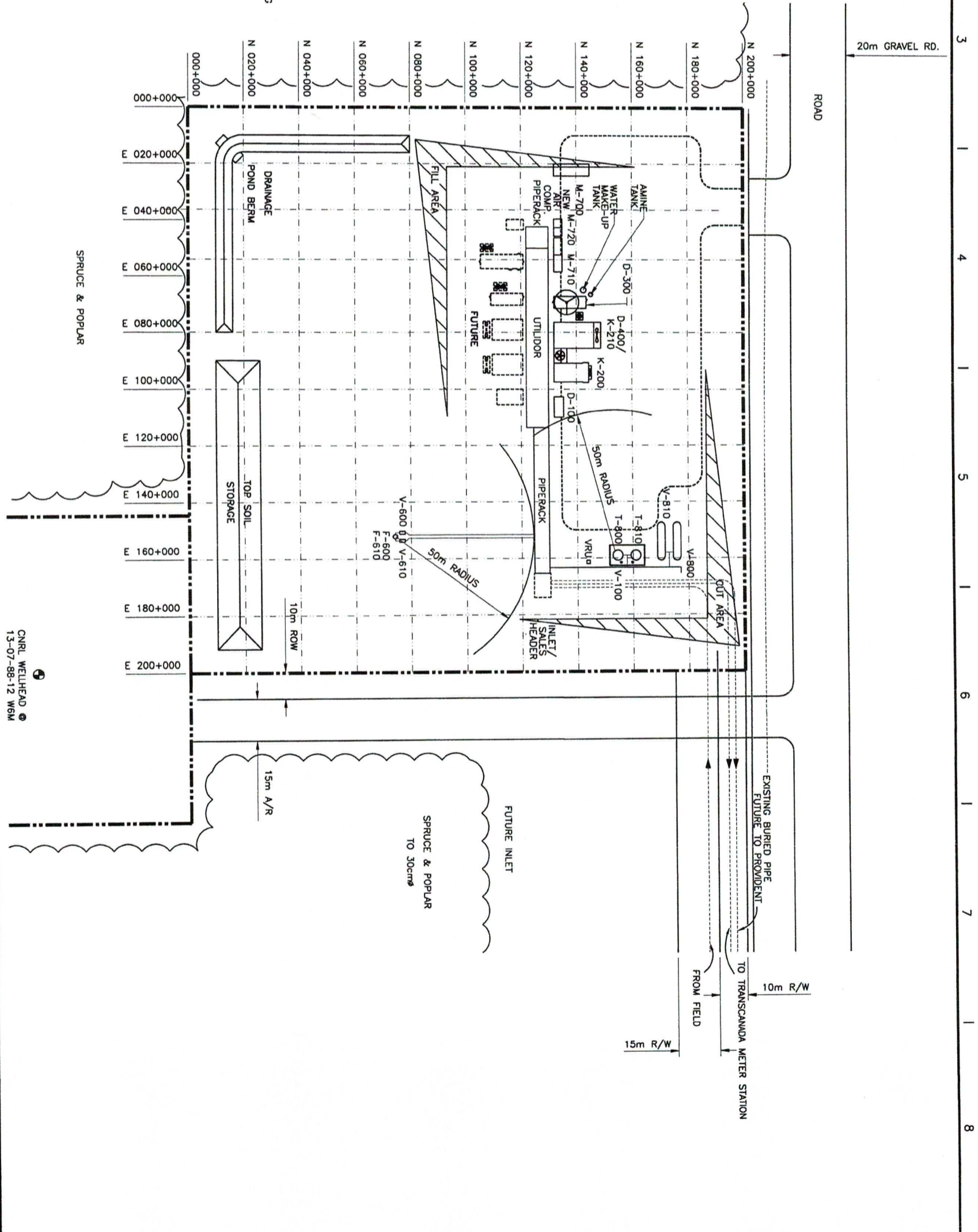

- LEGEND:**
- D-100 INLET SEPARATOR
 - D-300 AMINE
 - K-200 COMPRESSOR BUILDING
 - K-210/D-400 COMPRESSOR/REFRIG BUILDING
 - M-700 OFFICE BUILDING
 - M-710 MCC/UTILITY BUILDING
 - M-720 INSTRUMENT AIR BUILDING
 - T-800 SOUP WATER TANK
 - T-810 SOUP CONDENSATE TANK
 - V-100 TANK VENT SCRUBBER
 - V-800/V-810 LPG BUCKET
 - V-600/V-610 L.P./H.P. FLARE KNOCK OUT
 - F-600/V-610 L.P./H.P. FLARE
 - A/G PIPE U/G PIPE



CNRL WELHEAD
13-07-88-12 W6M

PROFESSIONAL ENGINEER
R.J.M. SIBERLAND
ALBERTA
8888

Not valid unless signed

PERMIT TO PRACTICE
STATUS ENGINEERING ASSOCIATES LTD.
Signature: *R.M. Sullaby*
Date: *14 August 2007*
PERMIT NUMBER: P 4515
The Association of Professional Engineers,
Geologists and Geophysicists of Alberta

Number	Reference Drawings	No.	Revision	By	Date	Chk.	App.	Date:
		1	AS BUILT	BP	07-07-31			07-01-17
		0	ISSUED FOR CONSTRUCTION	JGB	07-06-04			
		C	RE-ISSUED FOR APPROVAL	BP	07-05-14			
		B	RE-ISSUED FOR APPROVAL	BP	07-03-23			
		A	ISSUED FOR APPROVAL	BP	07-01-29			

<p>STATUS ENGINEERING ASSOCIATES LTD. 510, 101-11th Street SW, Calgary, AB, Canada T2E 1L5 808 (403) 243-4422 (t) (403) 228-1128 f-tele: drawing@ataeng.com</p> <p style="text-align: center;">AtaGas</p> <p style="text-align: center;">PLOT PLAN LATHROP CREEK GAS PLANT LSD 13-07-88-12 W6M</p>	<p>Project No. 6-1015-225 Drawing Number 1015-225-16</p>
--	--