

W360X45 BOLTING DETAIL (M/S)

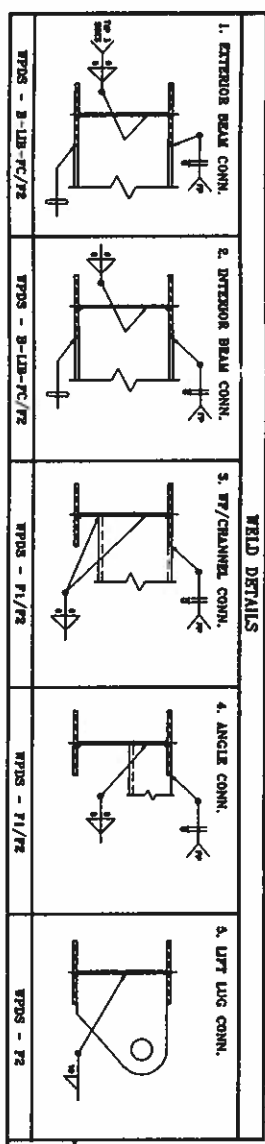
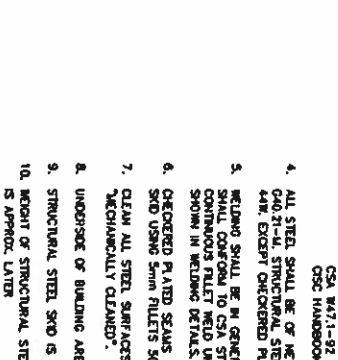
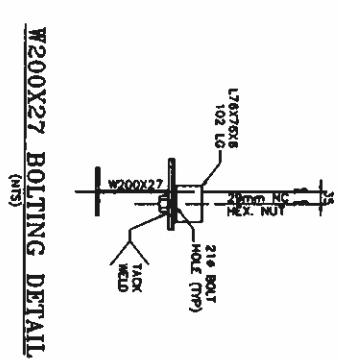

(1) REQ'D
TIME CARD
02-025-SK

REV.	DESCRIPTION	DATE	APP'D.	DATE	BY	DATE
Δ	ISSUED FOR CONSTRUCTION			02-03-11	TS	02-03-11
	PROJECT CO-ORDINATOR CHECKED					

ORBAN INDUSTRIES LTD.
CALGARY, ALBERTA

JOARCAM 11-13 BATTERY/11-13-50-22 W4M
STRUCTURAL STEEL FOR WATER DISPOSAL PUMP
SKID PACKAGE (SOUR SERVICE)

ENERMARK INC.
c/o TUXILA GAS ENGINEERING LTD.

DATE: 02-03-11
SCALE: 1:30

02-025-F

GENERAL STRUCTURAL STEEL NOTES:

- THIS DRAWING TO BE READ IN CONJUNCTION WITH THE PIPING PLAN DRAWING No. 02-025-E.
- ALL DIMENSIONS ARE IN MILLIMETERS UNLESS NOTED. ALL ELEVATIONS ARE REFERRED FROM TOP OF SFD FLOOR.
- ALL WORK SHALL GENERALLY CONFORM TO THE LATEST EDITIONS OF THE FOLLOWING CODES AND STANDARDS:
CSA W471-02
CSA W471-02
CANADIAN HANDBOOK OF STEEL CONSTRUCTION
- ALL STEEL SHALL BE OF NEW STOCK AND SHALL BE IN ACCORDANCE WITH CSA G40.21-UL STRUCTURAL STEEL SHALL GRADE 300K. PLATE MATERIAL SHALL BE 44K. EXCEPT CHECKERED PLATE TO BE A-36.
- WELDING SHALL BE IN GENERAL CONFORMANCE WITH CSA W8-1989. FULLER WETTING SHALL CONFORM TO CSA STD. W46.3-04 - E64022-0-04. WELDS TO BE 6mm CONTINUOUS FULLY WELD UNLESS NOTED. USE ORBAN WELDING PROCEDURE AS SHOWN IN WELDING DETAILS.
- CHECKERED PLATED SEAMS TO BE WELDED CONTINUOUSLY ON ONE SIDE. SITCH WELD TO SFD USING 6mm FILLET 30mm AT 300mm INTERVALS.
- CLEAN ALL STEEL SURFACES PRIOR TO PAINTING TO SSPC-SP3 MECHANICALLY CLEANED.
- UNDERCOAT OF BUILDING AREA SHALL BE INSULATED WITH 2" URETHANE.
- STRUCTURAL STEEL SFD IS DESIGNED TO 6-POINT LIFT.
- WEIGHT OF STRUCTURAL STEEL SFD (INCLUDING 2" URETHANE INSULATION) IS APPROX. 14700.

MAR 26 2002

