

REV#	DESCRIPTION	DATE	APPROVED
1			

Certified Correct for Construction Date: _____
 Submitted for Approval Date: _____
 Unit will be Released for Production only after the return of this Drawing Marked "Approved".

ENCLOSURE PERFORMANCE SPECIFICATION:

ENCLOSURE WALL TRANSMISSION LOSS	
63	125 250 500 1K 2K 4K 8K
15	21 25 29 35 40 40 43
DISCHARGE SILENCER DIL	
63	125 250 500 1K 2K 4K 8K
6	12 17 30 40 36 33 22
INLET SILENCER	
63	125 250 500 1K 2K 4K 8K
4	9 14 24 35 33 30 20

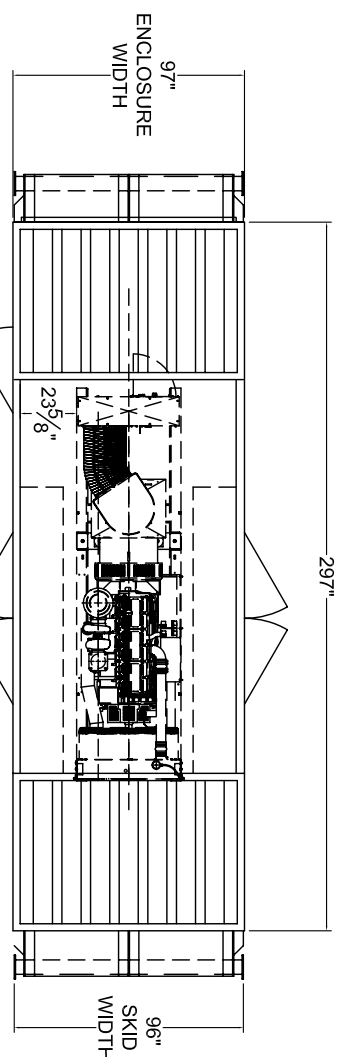

- Construction:**
- 16GA SATIN COAT STEEL
 - PAINT COLOR: STONE GRAY
 - 3" ROXUL ACOUSTIC INSULATION
 - 18GAUGE ALUMINUM PERF LINER
 - ROOF MOUNTED EXHAUST SILENCER
 - ACOUSTICALLY TREATED DBL. DOOR
 - ACOUSTICALLY TREATED SINGLE DOOR
 - ENCLOSURE INLET AND DISCHARGE SILENCERS ROOF MOUNTED
 - PACKAGE SKID FOR ROLL DROP
 - ROOF THIMBLE EXHAUST FLEX, CLAMPS, TUBING, FLANGE KITS TO INCLUDE BOLTING AND GASKETS.
 - POWER VENTILATION THERMOSTATICALLY CONTR
 - RAD PONY WALL
 - RAD ROOM REFLECTOR PLATE AND DRAIN
 - (1) RAD DISCHARGE ROOM ACCESS DOOR
 - SILENCER BARRIER SIDE WALLS WITH DRAIN DRAIN SLOTS
 - INLET WEATHER HOOD FIELD INSTALLED
 - SHIPPED IN 1 PIECE
 - FUEL TANK
 - ELECTRICAL
 - ELECTRICALLY ACTUATED DAMPERS

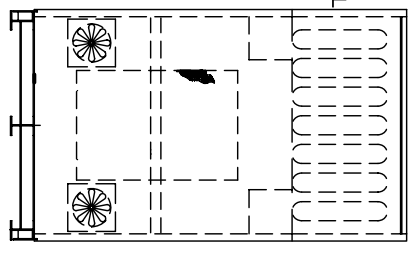
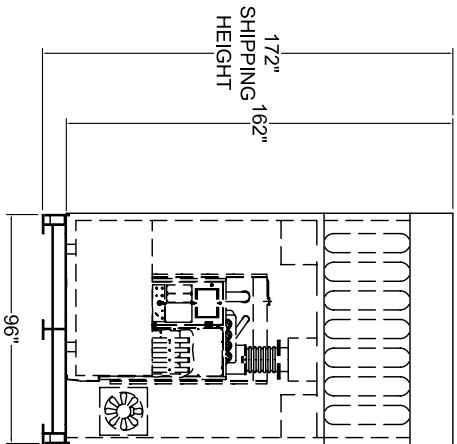
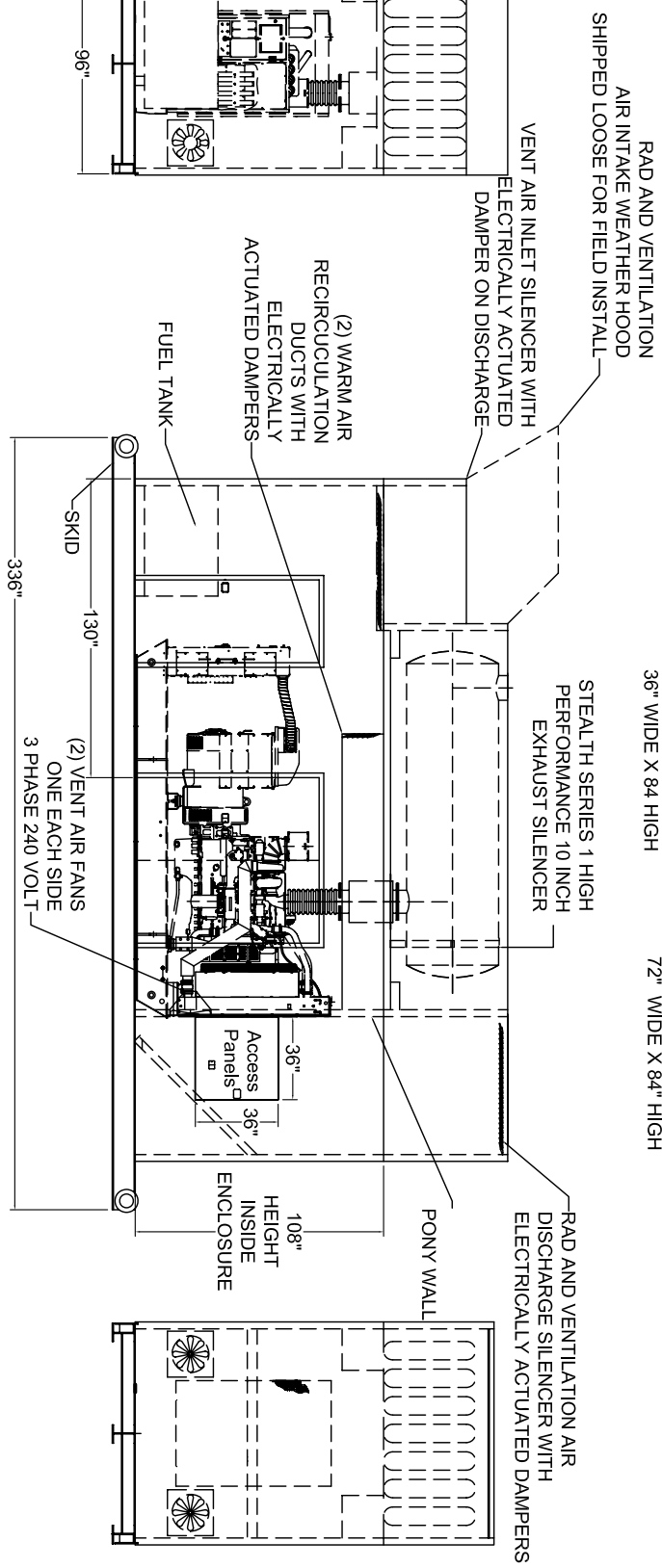

MODEL # **CAT 3456 SAEC PACKAGE** QTY **3** PROJECT # **06-3020** PRODUCT COLOR **STONE GREY** SHEET **1 of 1** LSP **Multiple** SCALE **NTS** DATE **OCT - 14-2006**

Drawings may not be transferred or reused without the written consent of Stealth Acoustical & Emission Control Inc.

STEALTH ACOUSTICAL & EMISSION CONTROL